

Atmosphyre

Perfecting Imperfection

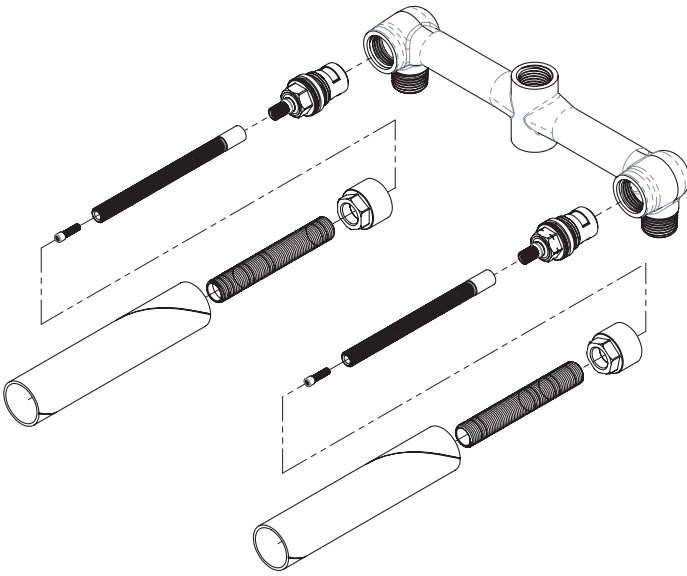

Bathhouse Wall Faucet Rough-in Installation

www.atmosphyre.com

■ 8090536AWV Wall Lav Set Valve

#	PART #	DESCRIPTION	QTY
1	10106	VALVE BODY, LAV INWALL	1
2	11540	CARTRIDGE 1/2" 20 PT HOT	1
3	11541	CARTRIDGE 1/2" 20 PT COLD	1
4	10054	STEM EXTENSION	2
5	92157	SCREW	2
6	11321	CARTRIDGE RETAINER NUT	2
7	10209	SHANK NIPPLE THREAD ALL	2
8	11648	MUD GUARD, CARDBOARD	2

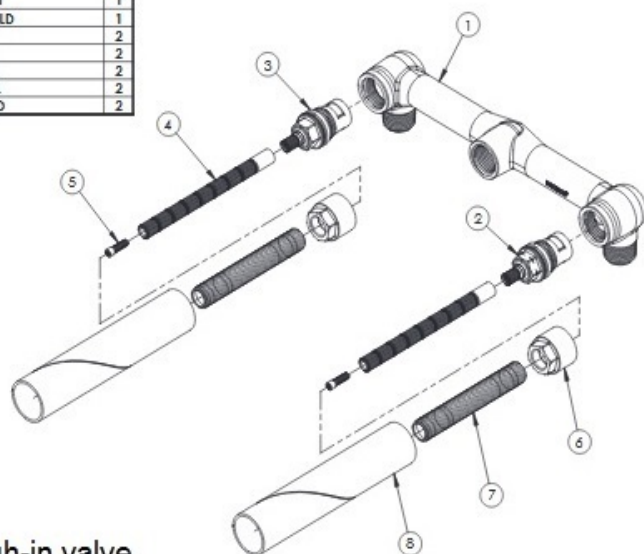

Location of rough-in valve

Water spout can be set at 7" or 7-1/2" or 8" out from finished wall

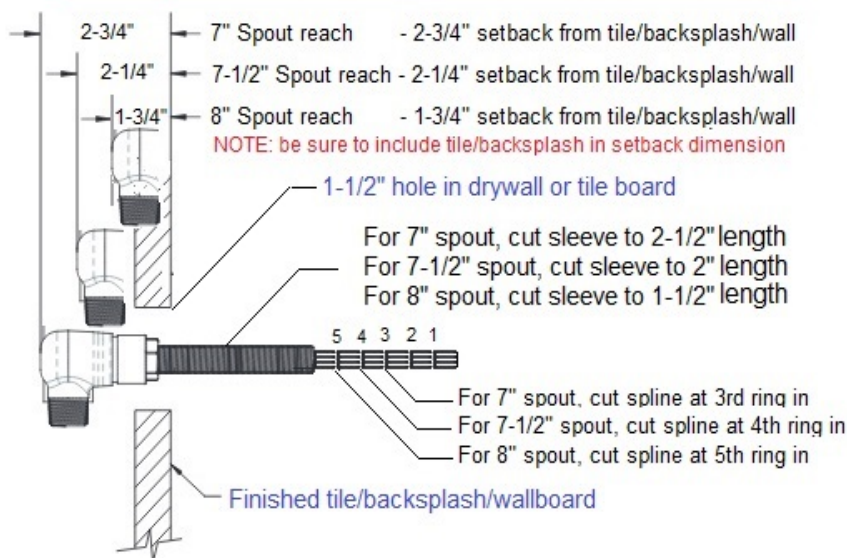

Before starting the installation determine first the **rough-in specs** to determine the proper location of the valve.
See page 6 for rough-in specs

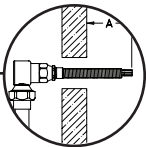

▪ **PART 1** Connection of Copper tubing/lines

Once the proper location has been determined secure the **valve**. Connect the **Copper lines** to the hot and cold supplies. **NOTE: COPPER LINES NOT PROVIDED**

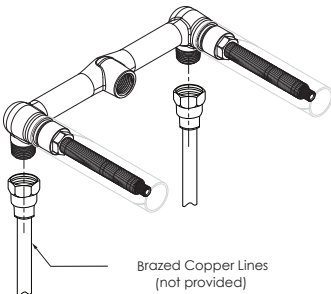

▪ **PART 2** Wall Lav Installation

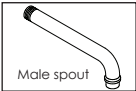

For Male spout : (No need to attach nipple.) Slide spout flange onto spout. Attach complete spout to the valve. **Wall is ready to be closed.**

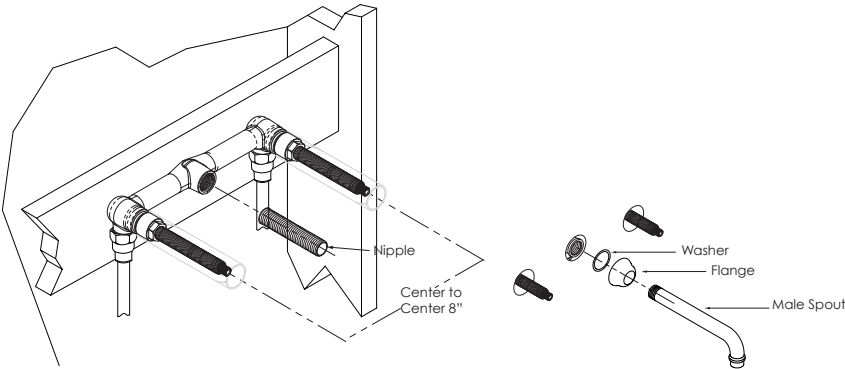

NOTE: Check all connections for leaks and flush all lines.

PROCEED TO PART 4 (Escutcheons & Handles)

To adjust the handles for level,
please visit our website at
www.atmosphyre.com/installs

•PART 4 (Escutcheons & Handles)

Once the **finished wall** is in place and the necessary installation finished, attach the **escutcheons and handles** to the stem assemblies.

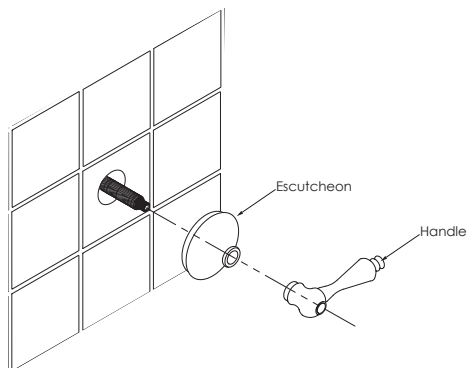

Proceed to the next step on how to fix trimming issues if applicable.

•TRIM OUT

INSTALLED TOO DEEP

If the valve is **installed too deep** behind the wall, **extension stems** are available. Please contact your local distributor to order part number **2-289 6 1/2"**

INSTALLED TOO FAR OUT

If the valve is **installed too far out of the wall**, the **stems and nipples** may be trimmed. To determine amount to be cut measure the gap between the **escutcheon and the wall** and/or the gap between the **handle and escutcheon**.

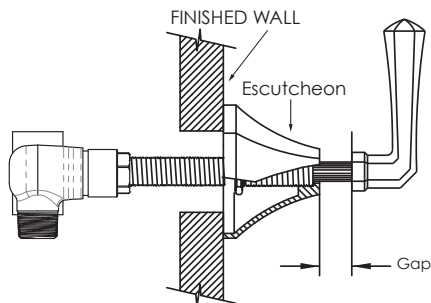

Remove **handle, escutcheon and stem assembly**, make appropriate **cuts** on stem and nipple. **Re - install** stem assemblies, escutcheons and handles.

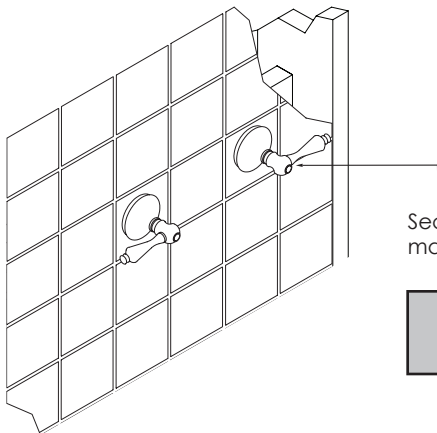

Secure handles using **setscrews** or 1/4-20 machine screws provided.

Your faucet is now ready to use.

ROUGH-IN SPECIFICATIONS

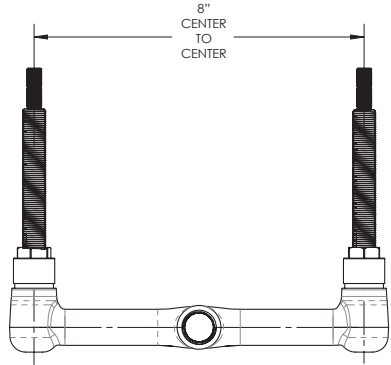
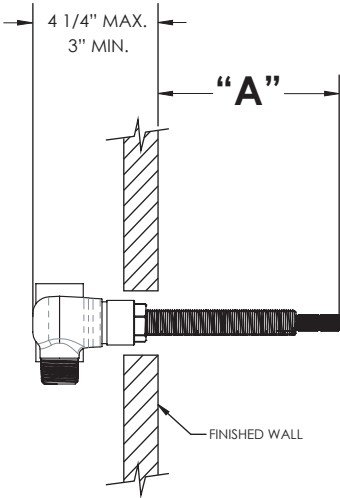

Note: If you ordered/ purchased a replacement for the cartridge follow the instructions below.

ADJUSTABLE CARTRIDGE KIT 2-197 (1/2" COLD) & 2-198 (1/2" HOT)

Warning: Before removing any plumbing make sure that the water line has been shut off

HANDLE ADJUSTMENT

1. Remove any existing cartridge & make sure that the **valve is free from any debris.**
2. Install new **cartridge.**
3. Rotate handle to desired "off" position (**3 o'clock or 9 o'clock**).
4. Remove handle and use a deep socket wrench (**12-14 ft-lb RECOMMENDED**) to secure the adjustment nut **DO NOT OVER TIGHTEN**
5. If the handle is heavy & starts to droop use a strap wrench on the **threaded nipple as needed**
6. **Reinstall** trim & handle

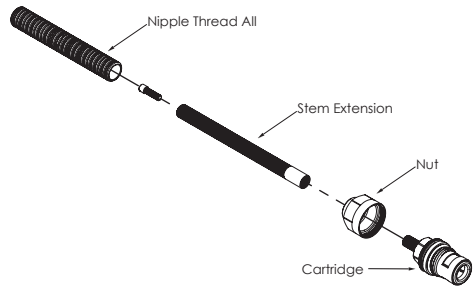

Atmosphyre

2706 New Scotland Rd, Voorheesville, NY 12186

www.atmosphyre.com/installs